

Installation with LVW900 model

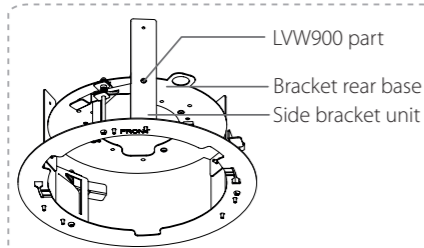

Note:
Fix the Bracket rear base to the LVW900 part in the Side bracket unit.

- 1 Assemble the Camera to the Flush Mount Bracket and tighten three screws (M4 x L6.0 mm).

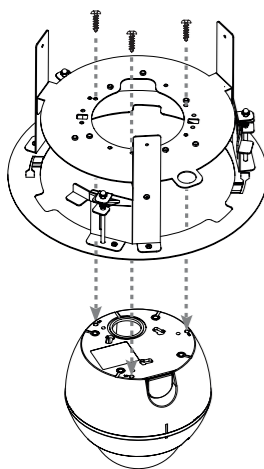
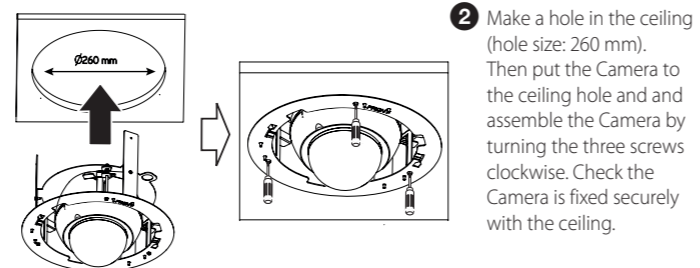

- 2 Make a hole in the ceiling (hole size: 260 mm). Then put the Camera to the ceiling hole and assemble the Camera by turning the three screws clockwise. Check the Camera is fixed securely with the ceiling.

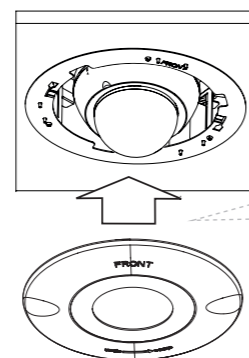

- 3 Assemble the Camera and Plastic cover.

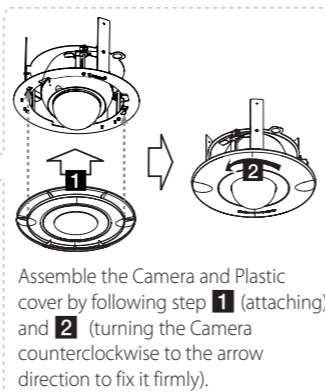

Assemble the Camera and Plastic cover by following step **1** (attaching) and **2** (turning the Camera counterclockwise to the arrow direction to fix it firmly).



Installation Guide Flush Mount Bracket

Model: LBK1000C

Accessories

- Flush mount bracket
- Plastic cover
- Mount adapter
- Installation manual
- Screw accessory
 - Screw Machine(M4 x L14.0 mm) (3 ea)
 - > LT713I, LT913I, LW9226I, LW9228I, LCP2850I, LW9422, LNP2810
 - Screw Machine (M4 x L6.0 mm) (4 ea)
 - > LW6324, LW6424, LVW900
 - Screw Tapping (Ø3 x L8.0 mm) (3 ea)
 - > LVW700, LW5224R

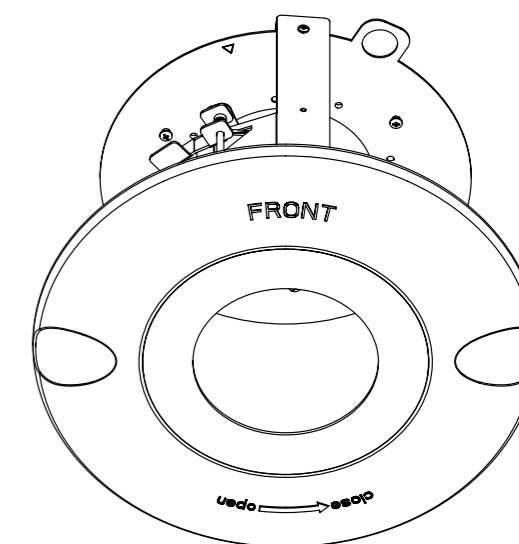

Appendix

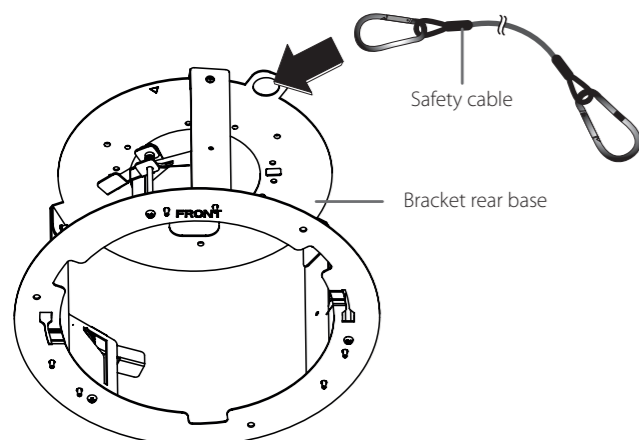

Use the Safety cable to the Bracket rear base for safety. The Safety cable is not supplied in the accessories.



Getting Started

Introduction

This product is designed for the flush mount of LG Dome camera on the ceiling.

The installable LG Dome Camera

- LT713I, LT913I, LW9226I, LW9228I, LCP2850I, LW9422, LNP2810, W6324, LW6424, LVW700, LW5224R and LVW900 models
- Refer to the owner's manual of LG Dome Camera for the compatibility of this product.
- Actual set may be differ from the picture described in this manual.

WARNING:

This product contains chemicals known to the State of California to cause cancer and birth defects or reproductive harm. **Wash hands after handling.**

Installation Precautions

Make sure that the installation place can endure at least 4 times of the total weight of the Flush Mount Bracket and Camera.

Specifications

- Net Weight: 1.3 kg
- Material: Aluminum
- Operating Temperature: -50 °C to 60 °C
- Operating Humidity: 0 to 100 %
- Dimensions (Ø x H):

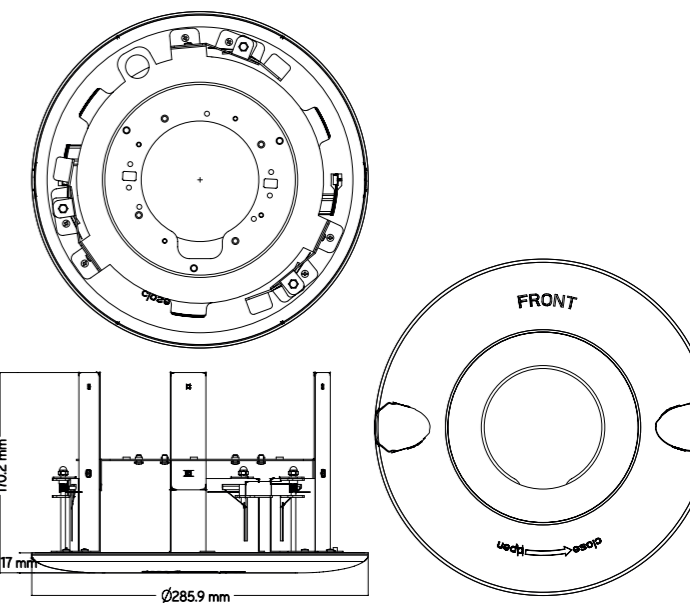

Installation with LT713I, LT913I, LW9226I, LW9228I and LCP2850I models

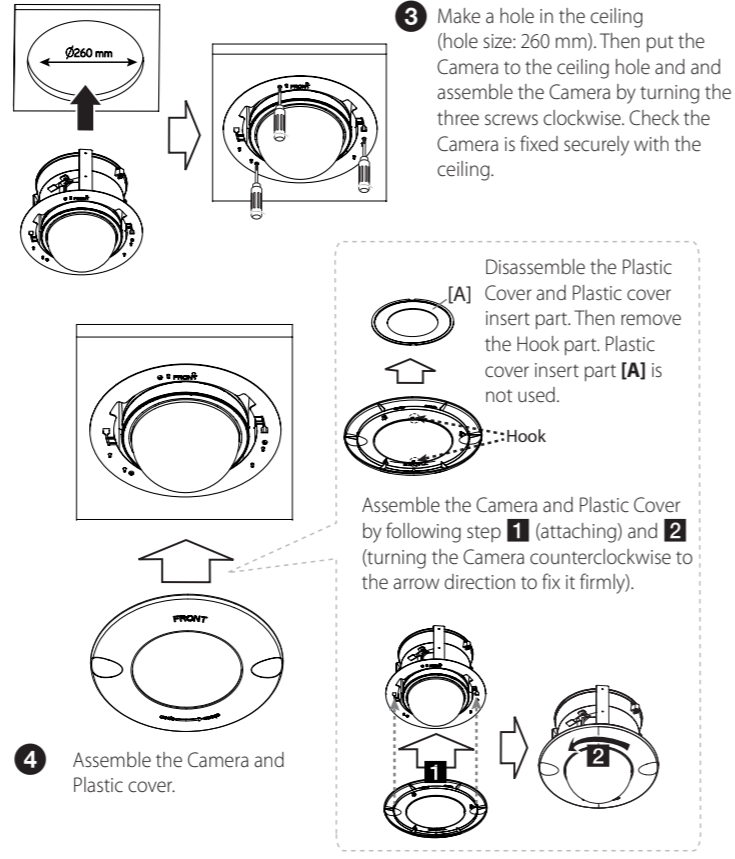
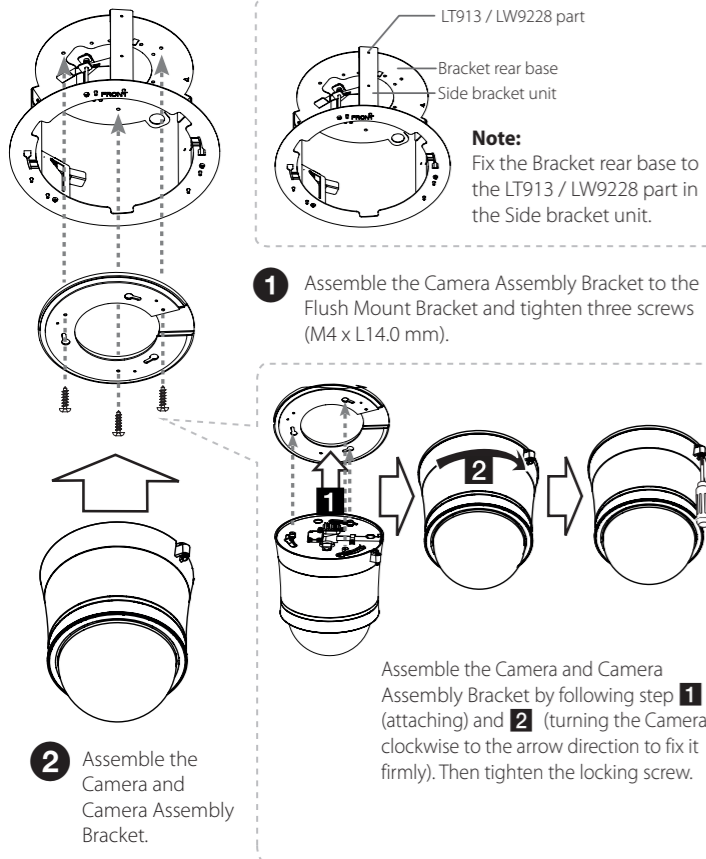

Installation with LW6324 and LW6424 models

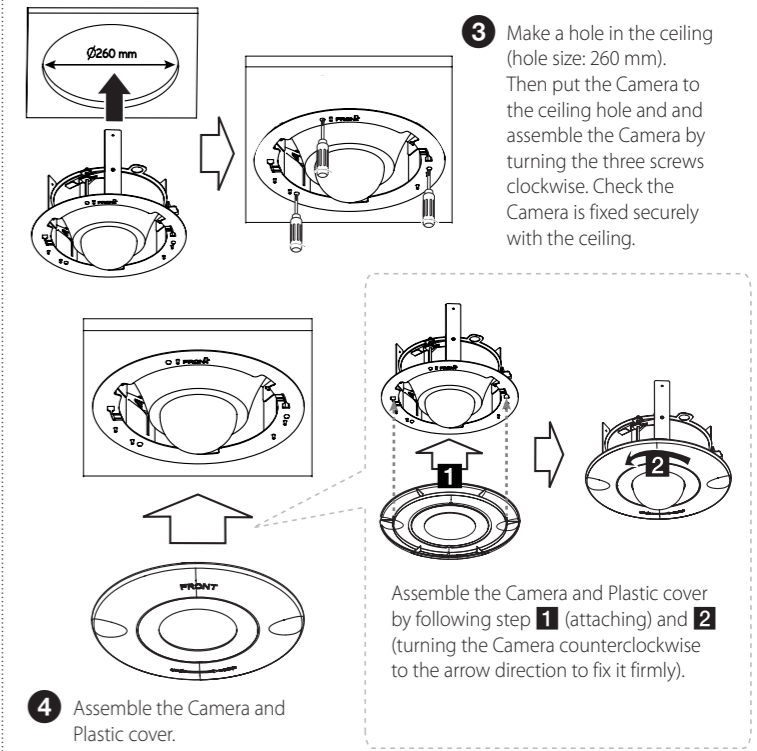
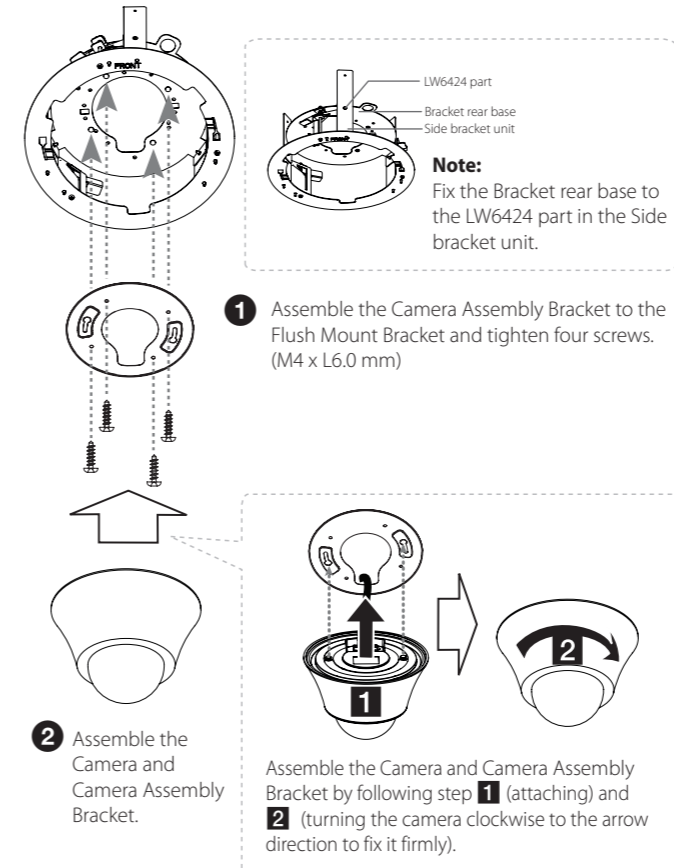

Installation with LW9422 and LNP2810 models

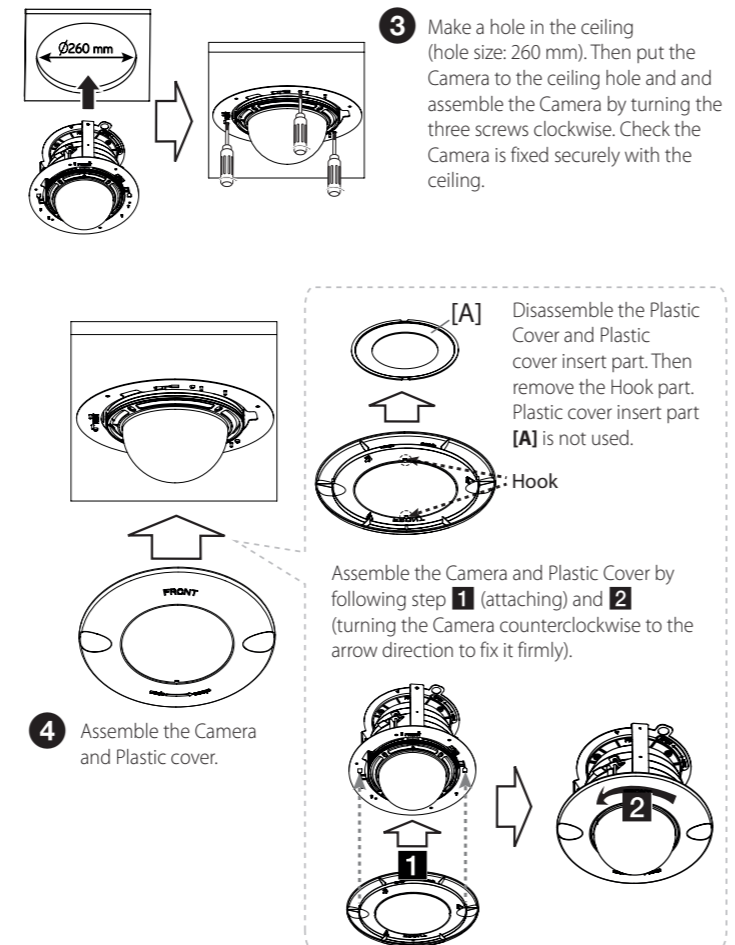
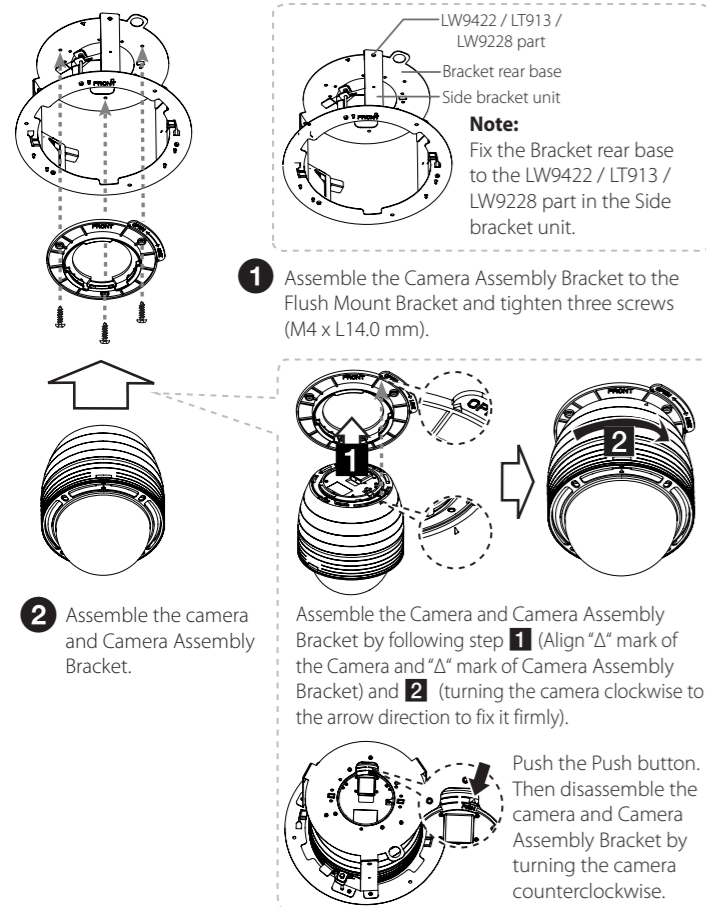

Installation with LVW700 and LW5224R models

