



OWNER'S MANUAL

Color Video Camera

Please read this manual carefully before operating your set and retain it for future reference.

MODEL
L5213-BN
L5213-BP
L5213-DN

P/NO : MFL63745101 (C)

Important Safety Instructions

- Read these instructions.
- Keep these instructions.
- Heed all warnings.
- Follow all instructions.
- Do not use this apparatus near water.
- Clean only with dry cloth.
- Do not block any ventilation openings. Install in accordance with the manufacturer's instructions.
- Do not install near any heat sources such as radiators, heat registers, stoves, or other apparatus (including amplifiers) that produce heat.
- Do not defeat the safety purpose of the polarized or grounding-type plug. A polarized plug has two blades with one wider than the other. A grounding type plug has two blades and a third grounding prong. The wide blade or the third prong are provided for your safety. If the provided plug does not fit into your outlet, consult an electrician for replacement of the obsolete outlet.
- Protect the power cord from being walked on or pinched particularly at plugs, convenience receptacles, and the point where they exit from the apparatus.
- Only use attachments/accessories specified by the manufacturer.
- Use only with the cart, stand, tripod, bracket, or table specified by the manufacturer, or sold with the apparatus. When a cart is used, use caution when moving the cart/apparatus combination to avoid injury from tip-over.
- Unplug this apparatus during lightning storms or when unused for long periods of time.
- Refer all servicing to qualified service personnel. Servicing is required when the apparatus has been damaged in any way, such as power-supply cord or plug is damaged, liquid has been spilled or objects have fallen into the apparatus, the apparatus has been exposed to rain or moisture, does not operate normally, or has been dropped.



Accessories

Installation sticker	
Camera mounting bracket	
M3 Fixing screws	

CAUTION
RISK OF ELECTRIC SHOCK
DO NOT OPEN

CAUTION: TO REDUCE THE RISK OF ELECTRIC SHOCK DO NOT REMOVE COVER (OR BACK) NO USER-SERVICEABLE PARTS INSIDE REFER SERVICING TO QUALIFIED SERVICE PERSONNEL.

- This lightning flash with arrowhead symbol within an equilateral triangle is intended to alert the user to the presence of uninsulated dangerous voltage within the product's enclosure that may be of sufficient magnitude to constitute a risk of electric shock to persons.
- The exclamation point within an equilateral triangle is intended to alert the user to the presence of important operating and maintenance (servicing) instructions in the literature accompanying the product.

FCC WARNING: This equipment may generate or use radio frequency energy. Changes or modifications to this equipment may cause harmful interference unless the modifications are expressly approved in the instruction manual. The user could lose the authority to operate this equipment if an unauthorized change or modification is made.

REGULATORY INFORMATION: FCC Part 15

This equipment has been tested and found to comply with the limits for a Class A digital device, pursuant to Part 15 of the FCC Rules. These limits are designed to provide reasonable protection against harmful interference when the equipment is operated in a commercial environment. This equipment generates, uses, and can radiate radio frequency energy and, if not installed and used in accordance with the instruction manual, may cause harmful interference to radio communications. Operation of this equipment in a residential area is likely to cause harmful interference in which case the user will be required to correct the interference at his own expense.

- A suitable conduit entries, knock-outs or glands shall be provided in the cable entries of this product in the end user.

- Caution: Danger of explosion if battery is incorrectly replaced. Replaced only with the same or equivalent type recommended by the manufacturer. Dispose of used batteries according to the manufacturer's instructions.
- Holes in metal, through which insulated wires pass, shall have smooth well rounded surfaces or shall be provided with brushings.

This Class A digital apparatus complies with Canadian ICES-003. Cet appareil numérique de la classe A est conforme à la norme NMB-003 du Canada.

Warning: Do not install this equipment in a confined space such as a bookcase or similar unit.

Warning: Wiring methods shall be in accordance with the National Electric Code, ANSI/NFPA 70.

Warning: This is a class A product. In a domestic environment this product may cause radio interference in which case the user may be required to take adequate measures.

Warning: To reduce a risk of fire or electric shock, do not expose this product to rain or moisture.

Caution: This installation should be made by a qualified service person and should conform to all local codes.

Caution: To avoid electrical shock, do not open the cabinet. Refer servicing to qualified personnel only.

Caution: The apparatus shall not be exposed to water (dripping or splashing) and no objects filled with liquids, such as vases, shall be placed on the apparatus.

To disconnect power from mains, pull out the mains cord plug. When installing the product, ensure that the plug is easily accessible.

Specification

Item	L5213-BP	L5213-BN	L5213-DN
Signal System	PAL	NTSC	
Total Pixels	470 000 Pixels	410 000 Pixels	
Effective Pixels	440 000 Pixels	380 000 Pixels	
Image Device	6 mm Super HAD II CCD		
DSP	XDI-S2		
Lens	2.8 mm to 11 mm Vari-focal lens (F1.4)		
Digital Zoom	X8		
Synchronization System	Internal		
Scanning Frequency (H/V)	15.625 kHz / 50 Hz	15.734 kHz / 59.94 Hz	
Horizontal Resolution	620 TV Lines		
S/N Ratio	52 dB		
Minimum Illumination (30 IRE)	Color mode	0.06 lx (Sens-up OFF, F1.4)	
		0.0001 lx (Sens-up Auto, F1.4)	
	B/W mode	0.006 lx (Sens-up OFF, F1.4)	
		0.000 001 lx (Sens-up x128, F1.4)	
Control Method	Inner Key Button		
Video Output Signal	1 Vp-p Composite (75 Ω)		
Day & Night	Day / Night / Auto		
BACKLIGHT	OFF / BLC / HSBLIC		
DNR	3D-DNR (Off/Low/Middle/High)		

CE LG Electronics hereby declares that this/these product(s) is/are in compliance with the essential requirements and other relevant provisions of Directive 2004/108/EC, 2006/95/EC, and 2009/125/EC.
European representative :
LG Electronics Service Europe B.V.
Veluwezoom 15, 1327 AE Almere,
The Netherlands (Tel : +31-(0)36-547-8888)

Disposal of your old appliance

- When this crossed-out wheeled bin symbol is attached to a product it means the product is covered by the European Directive 2002/96/EC.
 - All electrical and electronic products should be disposed of separately from the municipal waste stream via designated collection facilities appointed by the government or the local authorities.
 - The correct disposal of your old appliance will help prevent potential negative consequences for the environment and human health.
 - For more detailed information about disposal of your old appliance, please contact your city office, waste disposal service or the shop where you purchased the product.
- <For Turkey only>**
- EEE Compliance with Directive. (EEE Yönetmeliğine Uygundur.)



Item	L5213-BP	L5213-BN	L5213-DN
Auto Gain Control	Off / Low / Middle / High		
Electronic Shutter Speed	1/50 to 1/90 000	1/60 to 1/90 000	
Electronic Sensitivity	OFF/Auto		
White Balance	ATW / AWC → PUSH / Manual		
Motion Detection	4 Zones		
Privacy Zone Masking	8 Masks		
Stabilizer(EIS)	On / Off		
User Color Mode	STANDARD/COOL/WARM/VIVID		
Power Source	DC 12 V / AC 24 V	DC 12 V	
Power Consumption	2.8 W	2.2 W	
Operation Temp.	-10 °C to 50 °C		
Storage Temp.	-20 °C to 60 °C		
Operation Humidity	0 % RH to 80 % RH		
Storage Humidity	0 % RH to 85 % RH		
Weight	323 g		
Dimension (Ø x H)	Ø 140 x 87.3 mm		

Installation Guide

1

Using the template as a guide, make a hole through the ceiling.

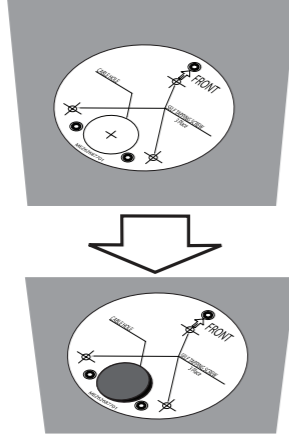

2

Install the camera mounting bracket to the ceiling.

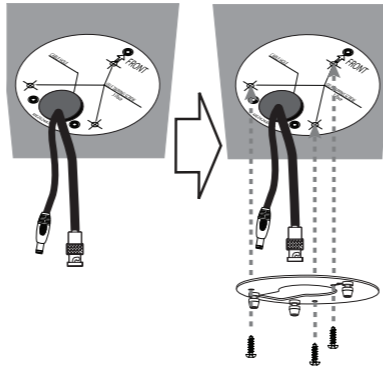

3

Connect the cables to the cable jacks of the camera body.

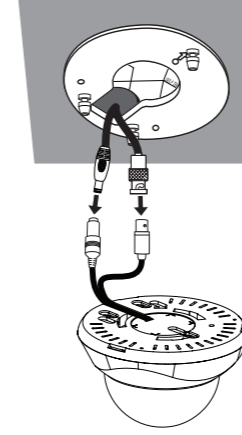

4

Assemble the camera and mounting bracket as illustrated step **1** and **2**.

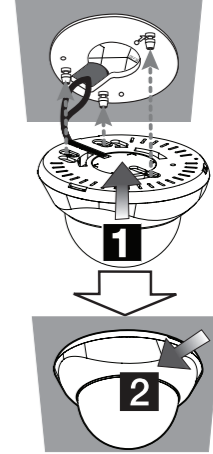

- <한국어> 라벨을 이용하여 천장에 구멍을 뚫어 주세요.
- <日本語> テンプレートを使用して穴位置を決め、天井に穴を開けます。
- <简体中文> 使用模板作为指引，在天花板上打一个孔。
- <繁體中文> 利用模板作為輔助，在天花板上鑽一個洞。
- <فارسی> از قالب بعنوان راهنما استفاده نموده و یک سوراخ در سقف ایجاد نمایید.
- <عربي> باستخدام النموذج كدليل، قم بعمل فتحة في السقف.

- <한국어> 카메라 설치 브래킷을 천장에 설치하세요.
- <日本語> カメラ取付け金具を天井に取り付けます。
- <简体中文> 将摄像机安装架安装到天花板。
- <繁體中文> 將攝影機底座托架安裝至天花板。
- <فارسی> پایه نگه دارنده دوربین را به سقف وصل کنید.
- <عربي> ركب دعامة تثبيت الكاميرا في السقف.

- <한국어> 전원 및 영상단자를 연결하세요.
- <日本語> ケーブルをカメラ本体のケーブル用端子に接続します。
- <简体中文> 将电缆连接到摄像机机身上的电缆插孔。
- <繁體中文> 將連接線連接至攝影機本體的連接線插孔。
- <فارسی> سیم ها را به جک های نگه دارنده آنها بر روی بدنه دوربین متصل کنید.
- <عربي> وصل الكابلات بمقابس الكابلات في جسم الكاميرا.

- <한국어> 그림과 같이 **1**, **2** 순서로 카메라 마운트 브래킷에 카메라를 결합하세요.
- <日本語> 手順 **1** と **2** の図のように、カメラと取付け金具を組み立てます。
- <简体中文> 按图中步骤 **1** 和 **2** 所示装配摄像机和安装架。
- <繁體中文> 如圖例步驟 **1** 及 **2** 所示，組裝攝影機與底座托架。
- <فارسی> بر طبق شکل های **1** و **2** دوربین و پایه نگه دارنده آن را به هم وصل نمایید.
- <عربي> ركب الكاميرا ودعامة التثبيت كما هو موضح في الخطوة **1** و **2**.

Camera Adjustment

1

Connect a portable monitor to the video jack.

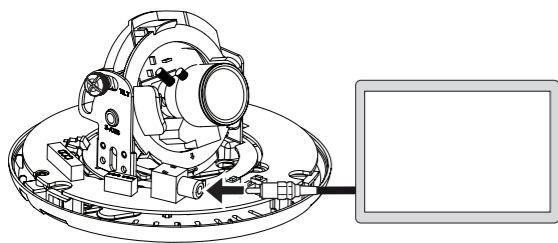

2

Adjust the Pan/Tilt position of the camera.

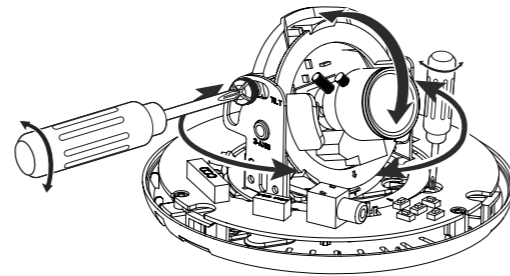

3

Adjust the azimuth angle.

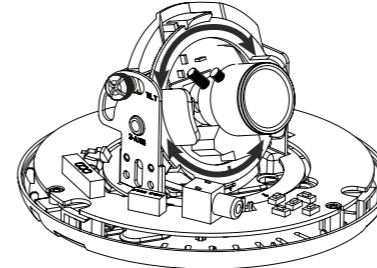

4

Adjust the zoom and focus.

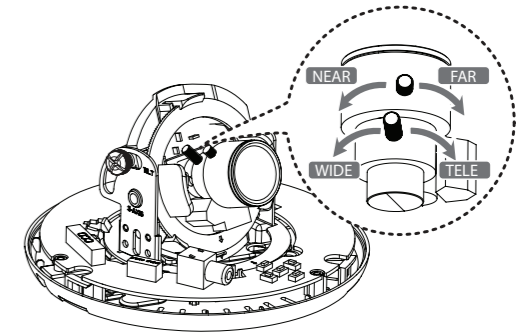

- <한국어> 모니터를 영상단자에 연결하세요.
- <日本語> ポータブルモニターを映像端子に接続します。
- <简体中文> 连接便携式监视器到视频插孔。
- <繁體中文> 將可攜式顯示器連接至視訊插孔。
- <فارسی> یک مانیتور قابل حمل را به جک ویدئو متصل کنید.
- <عربي> وصلة شاشة محمولة بمقابس الفيديو.

- <한국어> 상하 또는 좌우 각도를 알맞게 조절하세요.
- <日本語> カメラのパンとチルトの位置を調整します。
- <简体中文> 调节摄像机的摇摆/倾斜位置。
- <繁體中文> 調整攝影機的水平旋轉/傾斜位置。
- <فارسی> وضعیت پن/تیلٹ دوربین را تنظیم کنید.
- <عربي> اضبط وضع الدوران/الإمالة للكاميرا.

- <한국어> 방위각을 조절하세요.
- <日本語> アジマス角度を調整します。
- <简体中文> 调节方位角。
- <繁體中文> 調整方位角度。
- <فارسی> زاویه افقی را تنظیم کنید.
- <عربي> اضبط زاوية السمٹ.

- <한국어> 줌과 초점을 조절 하세요.
- <日本語>ズームとピントを調整します。
- <简体中文> 调节变焦和对焦。
- <繁體中文> 調整縮放及對焦。
- <فارسی> زوم و فوکوس را تنظیم کنید.
- <عربي> اضبط التكبير/التصغير والتركيز.